

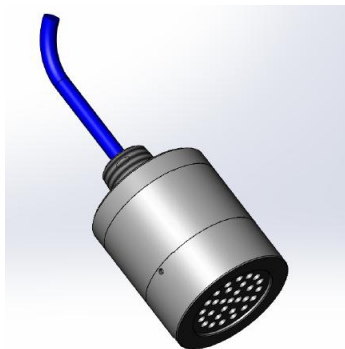

## LRCH01-005A



- √ Low power consumption;
- √ Fast response;
- √ Highly selective to Methane, anti- interference of other gases, moisture, or dust;
- √ 5.0V power supply RS232serial connection.

### ► Properties

Parameters	Min.	Typ.	Max.	Unit	
<b>Standard Parameters</b>					
Storage temperature	-40	-	70	°C	
Operate temperature	-40	-	70	°C	
Working humidity	-	-	98	%	
Working pressure	86	-	106	kPa	
Detecting range	0.00	-	5.0	%	
Basic tolerance	0.01~1.00% CH <sub>4</sub>		±1%FS		
	1.00~3.00% CH <sub>4</sub>		±3%FS		
	3.00~5.00% CH <sub>4</sub>		±5%FS		
Response time	-	15	20	s	
Min. Resolution	0.01			%	
<b>Communication Interface</b>					
RS232	Baud rate	-	115200	-	baud
	Data Bits	-	8	-	Bit
	Stop bits	-	1	-	Bit
	Check	-	-	-	Bit
<b>Electricity Properties</b>					
Working Voltage DC	-	5	-	V	
Working current DC	-	100	350	mA	
<b>Size</b>					
Dia.xLength (max)	57x 82			mm	



## ► Pin Definition

Pin symbols	Details
Red	+5V
White	GND
Blue	TX
Green	RX

## ► Communication Format

When the module is in detecting status, the output format will be ACSII string in fixed length, totally 29 bytes, format as follows:

**Symbol xxx.xx space symbol nn.n space pppp.pp space SS space HH<CR><LF>**

Symbol x.xx represents concentration, unit vol%, range -999.99~+999.99;

Symbol nn.n represents temperature, unit °C, range -99.9~+99.9;

pppp.pp represents gas pressure, unit mbar, range 0000.00~9999.99;

SS is the code represents the equipment's status.

HH is the Xor check values of the 25 bytes ahead, the check value is output in 2 character format;

<CR><LF> represents enter a new line.

For details, please refer to the communication protocol <Communication protocol of laser module V2.0.2>

## ► Size (unit: mm)

